

IF A FUSE BLOWS

GENERAL FEATURES

A fuse is an element for protecting the electrical system. A fuse will trip (i.e. blow) in the event of a failure or improper interventions in the electrical system.

If an electric device is not working, check whether the respective fuse is blown (i.e. the conductor is broken **fig. 33**). If required, replace the blown fuse with another with the same amperage (same colour).

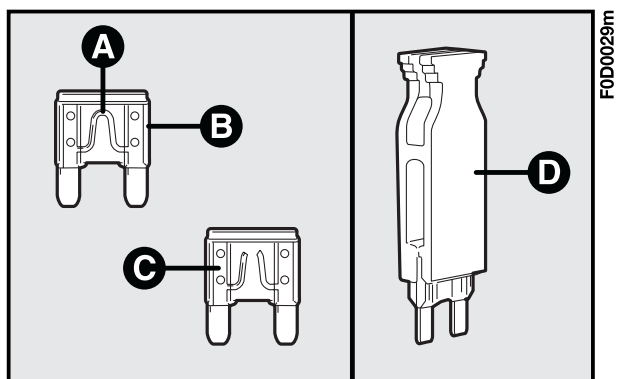

fig. 33

B - Undamaged fuse.

C - Fuse with broken filament.

Use the tongs **D** in the fusebox to extract the fuse.

To locate the fuse, refer to the tables on the following pages.



WARNING

If the fuse blows again, have the vehicle inspected at a Fiat Dealership.



Before changing a fuse, check the ignition key has been removed and that all the other electric devices have been turned off/disabled.



WARNING

Never change a fuse with another amperage: FIRE RISK!



Never replace a broken fuse with anything other than a new fuse. Always use a fuse of the same colour.



WARNING

Do not attempt to repair a blown MAXI-FUSE. Go to a Fiat Dealership.

POSITION OF THE FUSES

Four fuseboxes are provided: two fuseboxes are located at the dashboard ends, one is located in the engine compartment (near the air cleaner) and the last one is located on the battery positive pole **A**-fig. 34 (CBA).

To reach the first fusebox on the left-hand side of the dashboard (driver's side; passenger's side for right-hand drive version), loosen the two screws **A**-fig. 35.

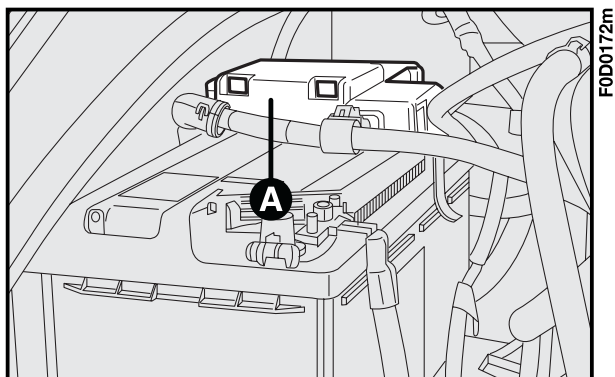

fig. 34

Fig. 36 - fusebox on the left-hand side (CFB) (driver's side; passenger's side for right-hand drive version).

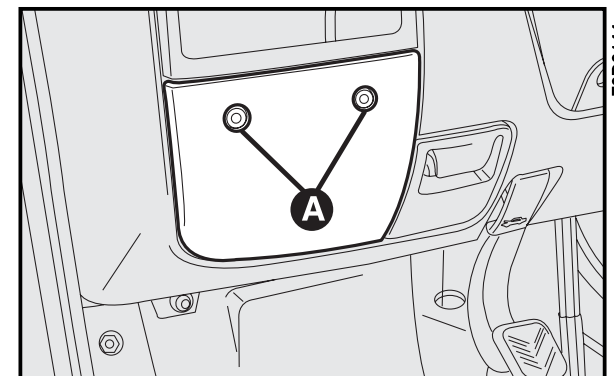

fig. 35

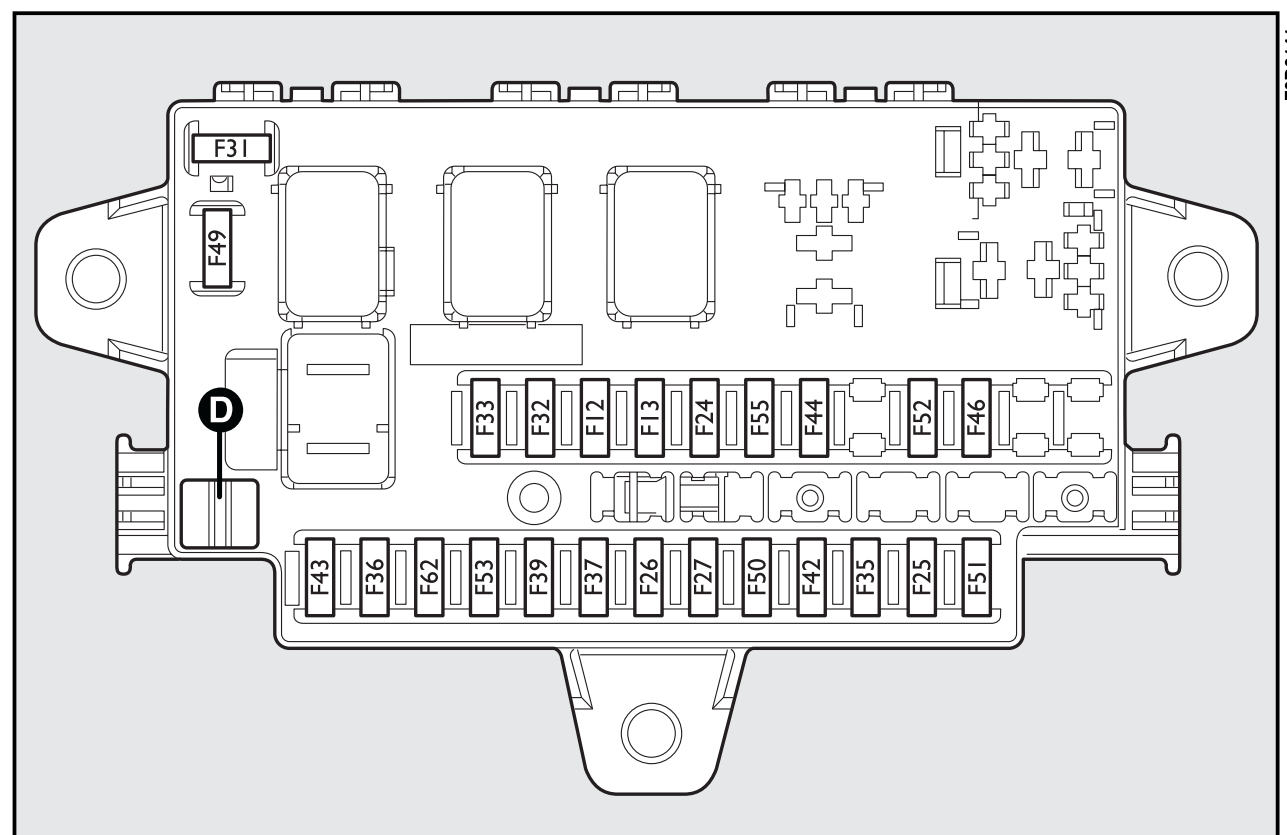

fig. 36

To reach the second fusebox on the right-hand side of the dashboard (passenger's side; driver's side for right-hand drive version), loosen the two screws **B**-fig. 37.

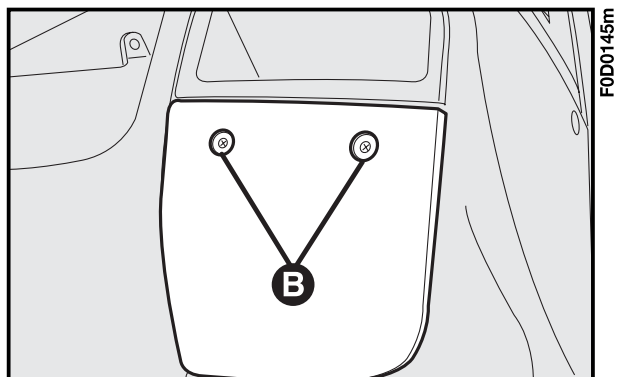

fig. 37

Fig. 38 - fusebox on the right-hand side (CFO) (passenger's side; driver's side for right-hand drive version).

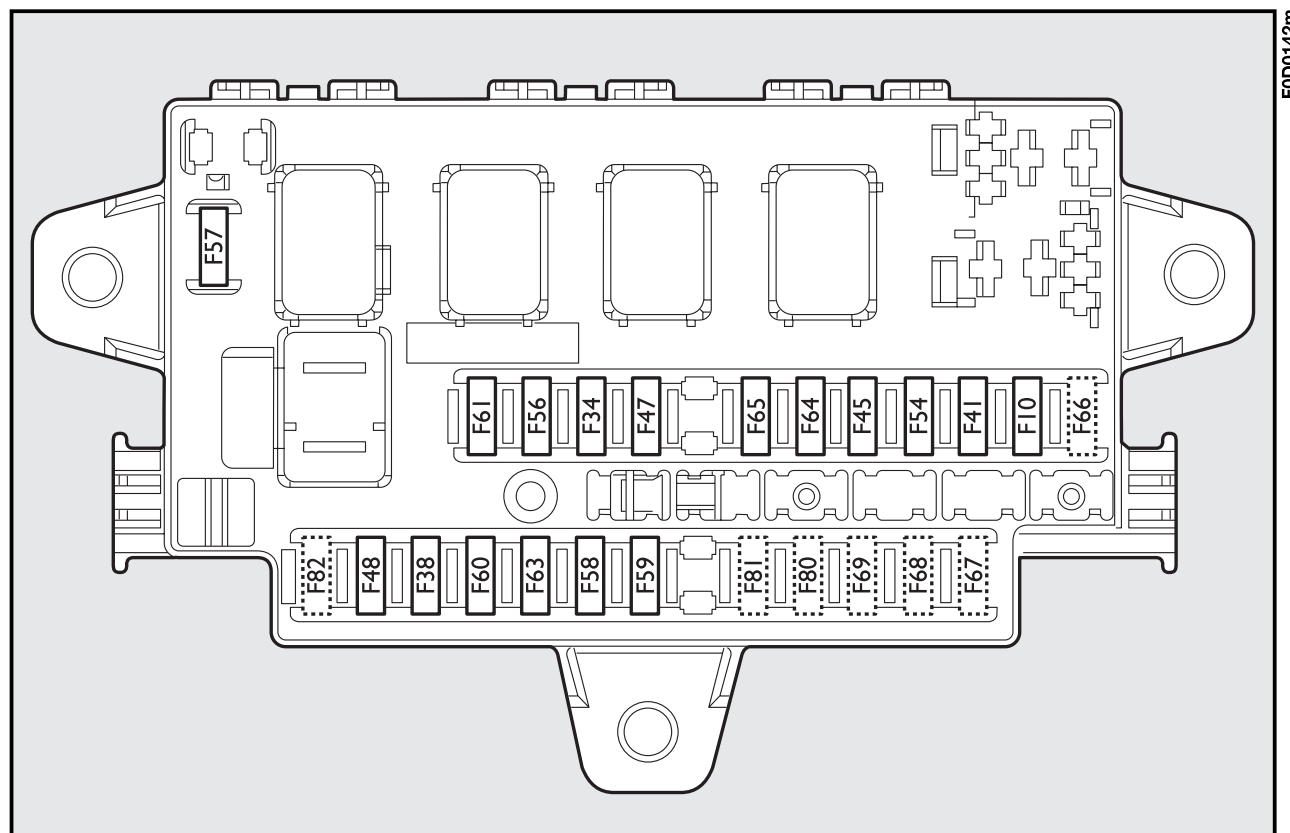

fig. 38

To reach the third fusebox (CVM) (**fig. 41**) in the engine compartment, remove the protective boot **A**—**fig. 39** then slacken the screw **B**—**fig. 40**, release fastener **C** and then remove cover **D**.

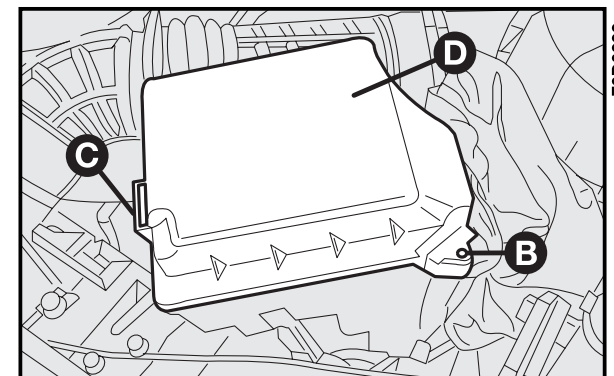

fig. 40

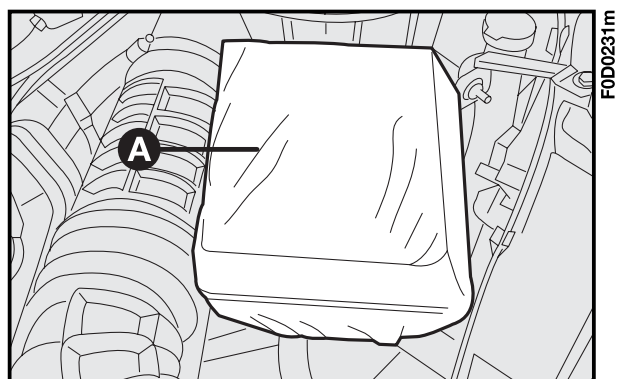

fig. 39

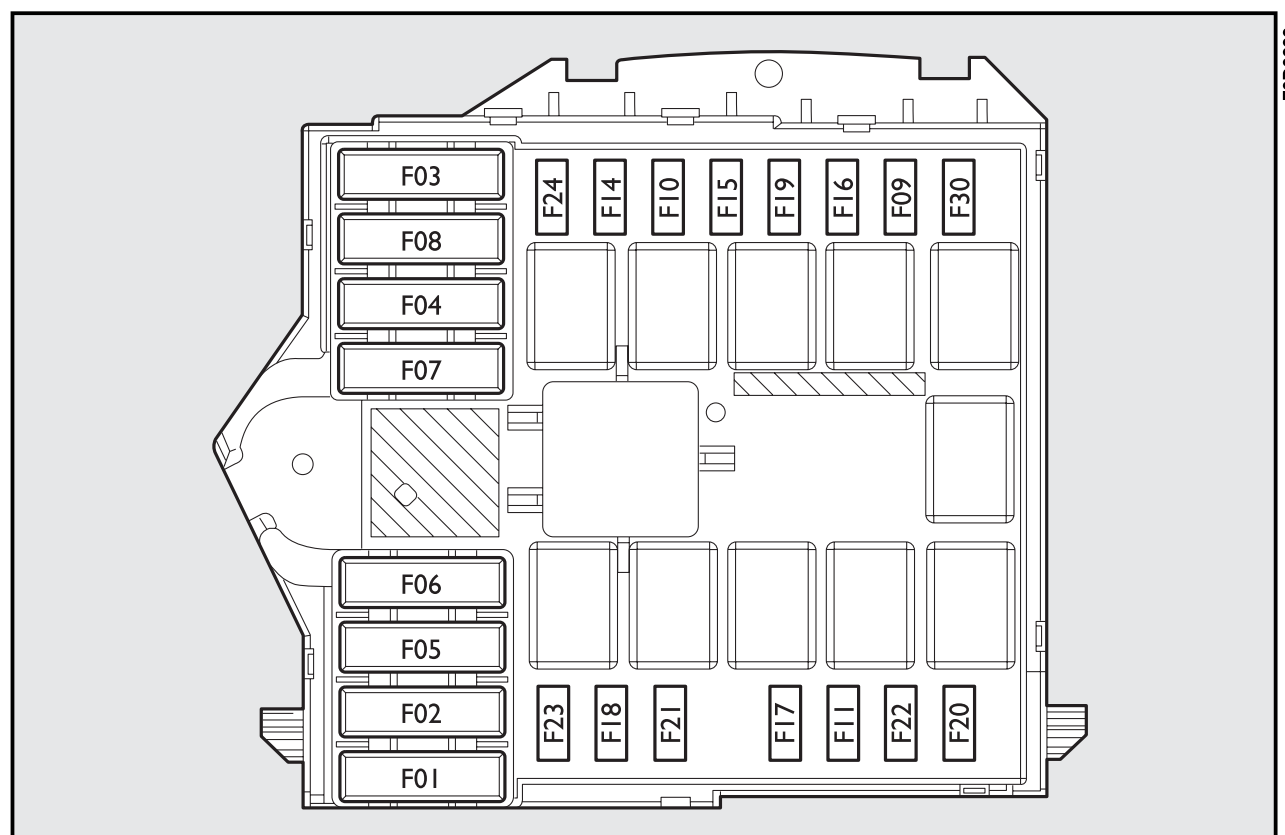

fig. 41

System/Component	Fuse no.	Ampere	Location
CBA (battery fusebox)			
Body-builders' current socket	F 73	70	Fig. 34
Alternator	F 72	125	Fig. 34
Alternator (2.0 - 2.0 JTD with heating system)	F 72	70	Fig. 34
Alternator (2.8 JTD with heating system - 2.0 JTD with climate control system)	F 72	100	Fig. 34
	F 70	150	Fig. 34
CVM protection	F 71	80	Fig. 34
CFO protection			
CFO (optional fusebox under the dashboard on passenger's side for LH drive versions, on driver's side for RH drive versions)			
Webasto unit	F 61	20	Fig. 38
Additional climate control	F 56	30	Fig. 38
Chronotachograph	F 34	10	Fig. 38
Phone	F 34	10	Fig. 38
Alarm	F 34	10	Fig. 38
Remote control	F 34	10	Fig. 38
ABI for right power window	F 48	20	Fig. 38
ABI for door lock	F 38	20	Fig. 38
Alarm blinker	F 60	10	Fig. 38
Rotating lights (Ambulance versions)	F 63	30	Fig. 38
Webasto timer	F 58	5	Fig. 38
ABI for left power window	F 47	20	Fig. 38
Food box power	F 59	15	Fig. 38
Additional heater fan	F 57	15	Fig. 38
Left heated rear window	F 54	15	Fig. 38
Door mirror defrosting device	F 41	10	Fig. 38
Right heated rear window	F 40	15	Fig. 38
Driver's seat warmer	F 45	15	Fig. 38

System/Component	Fuse no.	Ampere	Location
Rear current socket	F 64	20	Fig. 38
Siren (Ambulance versions)	F 64	20	Fig. 38
Suction fan (Minibus versions)	F 64	20	Fig. 38
Current socket for special set-up	F 65	10	Fig. 38
CFB (main fusebox under the dashboard on driver's side for LH drive versions, on passenger's side for RH drive versions)			
Windscreen washer pump	F 43	15	Fig. 36
Cigar lighter	F 44	15	Fig. 36
Cab heater fan	F 55	30	Fig. 36
Direction indicators	F 53	10	Fig. 36
Hazard lights	F 53	10	Fig. 36
Instrument panel	F 53	10	Fig. 36
Cab lights	F 39	10	Fig. 36
EOBD diagnostic socket	F 39	10	Fig. 36
Rear fog lights	F 33	7,5	Fig. 36
Radio	F 32	15	Fig. 36
Front current socket	F 52	20	Fig. 36
Headlight washer pump	F 49	15	Fig. 36
Front right-hand side light	F 12	5	Fig. 36
Rear right-hand side light	F 12	5	Fig. 36
Front left-hand side light	F 13	5	Fig. 36
Rear left-hand side light	F 13	5	Fig. 36
Number plate lights	F 24	5	Fig. 36
Side/taillight warning light	F 24	5	Fig. 36
Control lights	F 24	5	Fig. 36
PCA (Ambulance - Minibus versions)	F 51	10	Fig. 36
Radio	F 25	7,5	Fig. 36
ABI	F 35	7,5	Fig. 36
Door power window control	F 35	7,5	Fig. 36

System/Component	Fuse no.	Ampere	Location
ABS control unit	F 42	7.5	Fig. 36
Airbag control unit	F 50	7.5	Fig. 36
Power mirrors	F 27	7.5	Fig. 36
Cruise control	F 27	7.5	Fig. 36
Phone	F 27	7.5	Fig. 36
Chronotachograph	F 27	7.5	Fig. 36
Remote control	F 27	7.5	Fig. 36
Alarm	F 27	7.5	Fig. 36
Brake lights	F 26	7.5	Fig. 36
Instrument panel	F 37	10	Fig. 36
PCC	F 37	10	Fig. 36
Ignition switch	F 31	10	Fig. 36
Cab fan (with Webasto system)	F 55	30	Fig. 36
Webasto control unit	F 55	30	Fig. 36
Cab fan (with climate control)	F 55	30	Fig. 36
CVM (engine compartment fusebox)			
Radiator fan low-speed resistor (2.0 with climate control system)	F 06	40	Fig. 41
Engine control unit (2.0 with climate control system)	F 06	40	Fig. 41
Engine cooling fan (2.0 with climate control system)	F 06	40	Fig. 41
Engine control unit (2.0 with climate control system)	F 06	40	Fig. 41
Engine cooling fan (2.0 with climate control system)	F 07	40	Fig. 41
Engine control unit (2.0 with climate control system)	F 07	40	Fig. 41
CFB protection	F 01	60	Fig. 41
E.I. primary services	F 17	5	Fig. 41
E.I. primary services	F 22	20	Fig. 41
E.I. secondary services	F 11	10	Fig. 41
Horn	F 10	15	Fig. 41
Steering column stalk control	F 10	15	Fig. 41

System/Component	Fuse no.	Ampere	Location
Front fog lights	F 09	15	Fig. 41
Windscreen wiper motor	F 08	30	Fig. 41
Engine cooling fan 2nd speed	F 07	40/60	Fig. 41
Engine control unit 2nd speed	F 07	40/60	Fig. 41
Radiator fan 2nd speed remote switch coil (climate control)	F 07	40/60	Fig. 41
Engine cooling fan 1st speed	F 06	40	Fig. 41
Engine control unit 1st speed	F 06	40	Fig. 41
Cab fan (climate control)	F 05	30	Fig. 41
ABS control unit	F 04	50	Fig. 41
Ignition switch	F 03	30	Fig. 41
Glow plug preheating	F 02	50	Fig. 41
Right-hand dipped beam headlight	F 14	10	Fig. 41
Left-hand dipped beam headlight	F 15	10	Fig. 41
E.I. system	F 16	7.5	Fig. 41
Fiat code	F 16	7.5	Fig. 41
Automatic gearbox control unit	F 24	15	Fig. 41
Fiat code	F 18	7.5	Fig. 41
Compressor	F 19	7.5	Fig. 41
Engine control unit	F 18	7.5	Fig. 41
PTC	F 20	30	Fig. 41
Engine control unit	F 11	10	Fig. 41
Fuel pump	F 21	15	Fig. 41
Engine control unit	F 17	5	Fig. 41
Automatic gearbox control unit	F 23	10	Fig. 41
Main beam headlights	F 30	15	Fig. 41
Windscreen washer pump	F 08	30	Fig. 41