

244001146 – 3380A04 HANDBRAKE CHECK TRAVEL (Extract from x244 eLearn)

Position the vehicle on the lift. Remove both the rear wheels.

1. Working underneath the vehicle, loosen the handbrake adjustment nuts (1a), until the cable (1b) is slack.

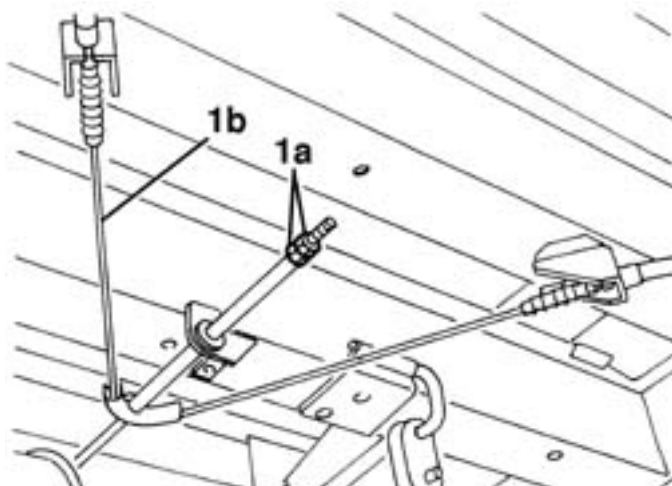

1a requires 2 x 13mm spanners

Carry out the following three stages on both sides of the vehicle.

1. Rotate the brake disc manually until one of the openings (1a) is in line with the toothed pin (1b) for the clearance recovery device.
2. Insert a screwdriver (2a) and, with the assistance of an electric torch, rotate the toothed pin upwards until the end of travel position (a condition in which the shoes are touching the brake drum).
3. Rotate the toothed pin (1b) by about 10 teeth in the opposite direction (downwards). This operation allows the correct clearance between the shoes and the drum to be re-established (the rotation of one of the teeth for the clearance recovery device toothed pin corresponds to a variation of 0.035 mm in the shoe diameter).

Subject	Value
3 Rear shoe adjustment device (Clearance between shoes and drum)	Mm 0.30 – 0.65

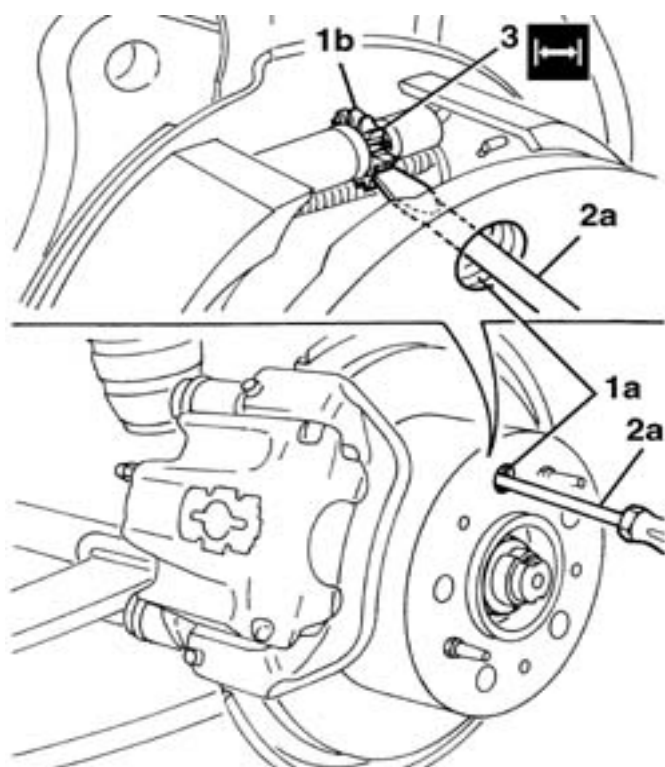

NB eLearn for the x250 states 5 teeth, instead of the 10 teeth mentioned above.
Clearance suggested is then only 0.15mm.

1. With the handbrake lever in the rest position, work underneath the vehicle and tighten the adjustment nut (1a) until the lever (1b) slowly becomes detached from the end of travel position on the bracket (1c); then lock the locknut (1d).

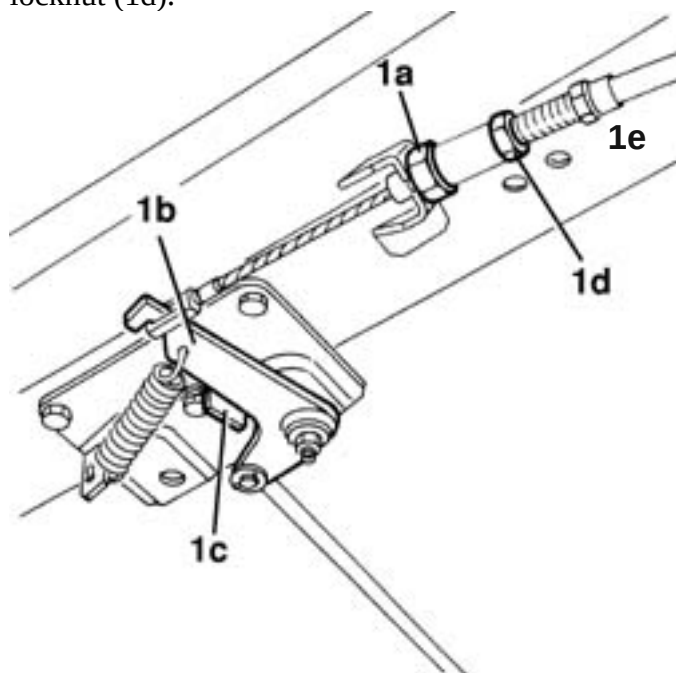

1a 22mm spanner
1d 19mm spanner
1e 14mm spanner

Place the handbrake lever at the third notch starting from the rest position.

1. Working underneath the vehicle, tighten the adjustment nut.

Value - daNm	Fastening	Component	Ø
1 0.25	Nut	HANDBRAKE CABLE ADJUSTMENT DEVICE -	

2. Check that when the handbrake lever is at the fourth notch the load on the grip is about 25 Kg, otherwise adjust the adjustment nut (1a) until the load is correct.

3. Tighten the locknut.

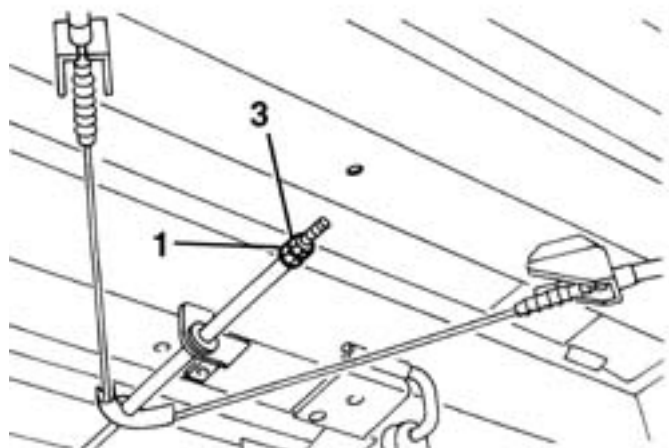
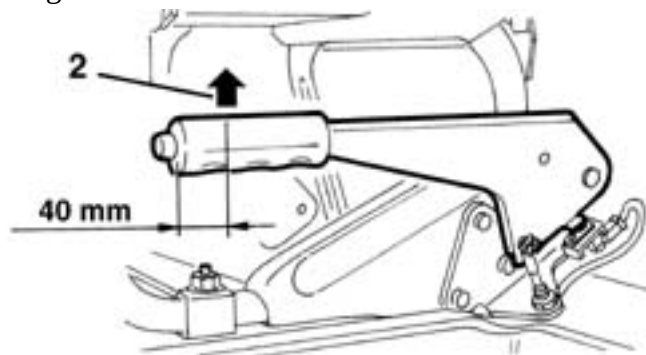

2 off 13mm spanners

Refit the rear wheels.

Remove the vehicle from the lift.

Check that the handbrake is working.